

# MINIATURE DIAPHRAGM

## Pumps & Compressors 2002 Series

### MODELS:

Standard models available.  
2002-0200

Other models based on availability and minimum purchase.

### FEATURES:

- Oil-less
- Maintenance free
- Low noise level
- Restart capability against pressure or vacuum
- Small, lightweight
- High efficiency

Consult factory for custom applications

### DIMENSIONS:

Millimeters are in ( )

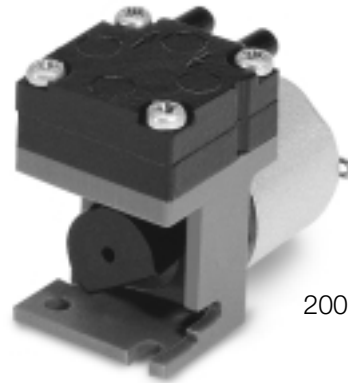

2002 G

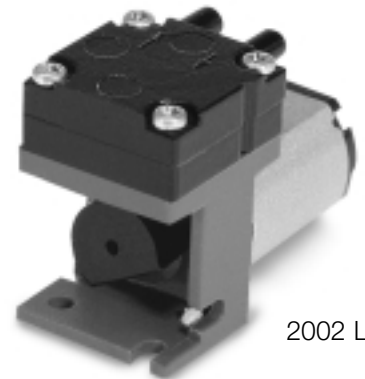

2002 L

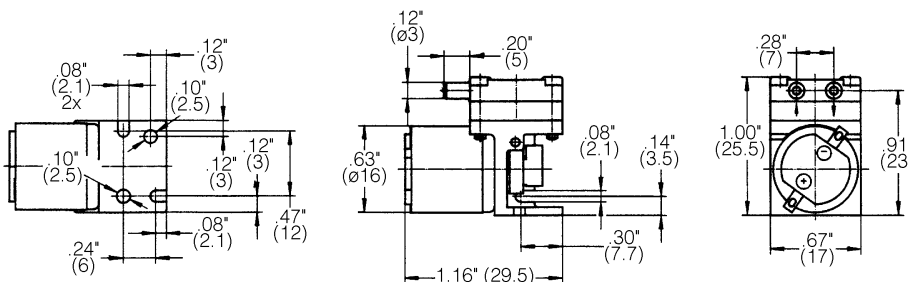

2002 G

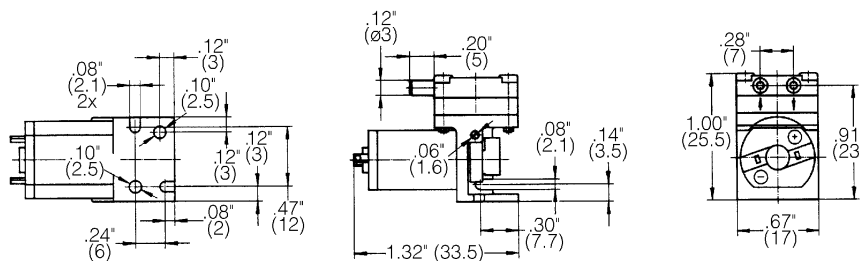

2002 L

# 2002 SERIES PERFORMANCE DATA:

<b>COMPRESSOR MODEL NUMBER:</b>		3.5v 5v 6v 12v	2002-0206 2002-0104 2002-0200-STANDARD 2002-0212	2002-0049  — —		
<b>PRESSURE:</b>			Flow @ 3.5v/5v/6v/12v		Flow @ 3.5v	
LPM @ PSI		LPM @ mbar				
PSI		mbar		LPM	LPM	LPM
0	0	.35	.35	.29	.29	
1	50	.22	.25	.19	.22	
2	100	.13	.18	.12	.17	
3	150	.10	.14	.10	.13	
4	200	.07	.10	.06	.10	
5	250	.03	.08	.01	.07	
	300		.05		.04	
	350		.03		.01	
<b>MAX. CONTINUOUS PRESSURE:</b>			2 PSI	150 mbar	2 PSI	150 mbar
<b>MAX. INTERMITTENT PRESSURE:</b>			5 PSI	370 mbar	5 PSI	370 mbar
<b>MAX. RESTART PRESSURE:</b>			2 PSI	150 mbar	2 PSI	150 mbar
<b>VACUUM:</b>			Flow @ 3.5v/5v/6v/12v		Flow @ 3.5v	
LPM @ IN. hg		LPM @ mbar (gauge)				
IN. hg		mbar (gauge)		LPM	LPM	LPM
0	0	.35	.35	.29	.29	
1	-50	.27	.24	.23	.22	
2	-100	.21	.17	.20	.17	
3	-150	.17	.12	.17	.12	
4	-200	.15	.08	.15	.08	
5	-250	.10	.04	.10	.05	
	-300		.02		.02	
	-350					
<b>MAX. VACUUM:</b>			10.4" hg	-350 mbar	10.4" hg	-350 mbar
<b>MAX. RESTART VACUUM:</b>			4.4" hg	-150 mbar	4.4" hg	-150 mbar
<b>AMBIENT TEMPERATURE:</b>			32°-122°F	0°-50°C	32°-122°F	0°-50°C
<b>MOTOR TYPE:</b>			DC		DC	
<b>MOTOR VOLTAGE:</b>			3.5/6/12		3.5/6/12	
<b>POWER CONSUMPTION (WATTS):</b>			.3		.3	
<b>INSULATION CLASS:</b>			E		E	
<b>WEIGHT:</b>			20g	20g	18g	18g

NOTE: 12v: Max. Pressure 380 mbar; Max. Flow .45 LPM

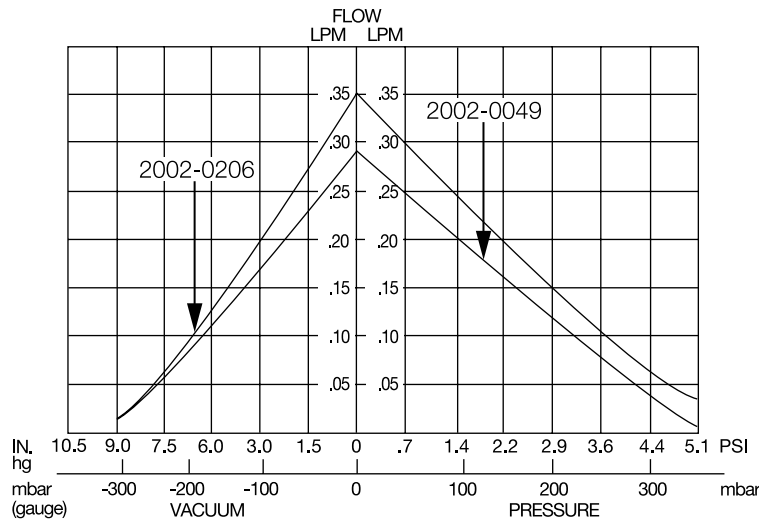

The information presented in this material is based on technical data and test results of nominal units. It is believed to be accurate and reliable and is offered as an aid to help in the selection of Thomas products. It is the responsibility of the user to determine the suitability of the product for his intended use and the user assumes all risk and liability whatsoever in connection therewith. Thomas Industries does not warrant, guarantee or assume any obligation or liability in connection with this information.

**Note:** Models pictured are representative of the series and do not represent a specific model number. Consult factory for detailed physical description.

